



advAnce

Arthroscopic & traumatologic surgery

PRODUCT CATALOG

advAnce

ARTHRO-SYSTEMS

3 *Aim-tec*<sup>®</sup> R O T A T O R

6 *Nec-plus*<sup>®</sup> A C L / P C L

8 *Aim-fix*<sup>®</sup> P L A T E & L O C K

8 *super-fiber*<sup>®</sup> L I G

9 *Aim-tec*<sup>®</sup> H A N D & F O O T

# Aim-tec® ROTATOR

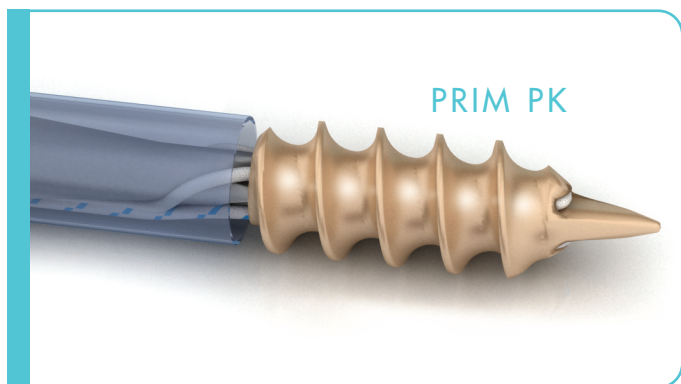

**PRIM PK**  
 POLYETHERETHERCETONE (PEEK) ANCHOR  
 PEEK screw type suture anchor system  
 for rotator cuff repair

## INDICATIONS

- Designed for soft tissue reattachment to bone :  
 5 & 6.5 mm Ø : shoulder
- Arthroscopic or open surgery.

## PROPERTIES

- Pre-drilling necessary in cancellous bone (impactor).
- Tapping necessary in cortical bone.

## FEATURES

- Preloaded anchor with two braided sutures of polyethylene suture Super-Fiber® #2 of different colors, set or not with suture needles (round 4/8 curved).
- Anchor available in different diameters : a solution for each surgical procedure.
- Adapted ancillary kit available.

## ADVANTAGES

- Ready to use anchor system.
- Adapted to Arthroscopic or open surgery with its own disposable screwdriver.
- Suture secured into screwdriver's grooves against thread torsion.
- Anchor may be easily removed by unscrewing, if necessary.
- Radiotransparent (without interference and interaction with X-ray imaging).

Class IIb Medical Device

ETO REF./Anchor/Thread/Needle					
	+	AVRP 52681 F	Ø 5 mm	L 800 mm	With
	+	AVRP 52690 F	Ø 5 mm	L 900 mm	Without
	+	AVRP 62681 F	Ø 6.5 mm	L 800 mm	With
	+	AVRP 62690 F	Ø 6.5 mm	L 900 mm	Without

Class I Medical Device

REF. Reusable instrumentation		
	AVRT 50000	Tap Ø 5 mm
	AVRT 65000	Tap Ø 6,5 mm
	AVRI 50000	Impactor instrument Ø 5 mm
	AVRI 65000	Impactor instrument Ø 6,5 mm

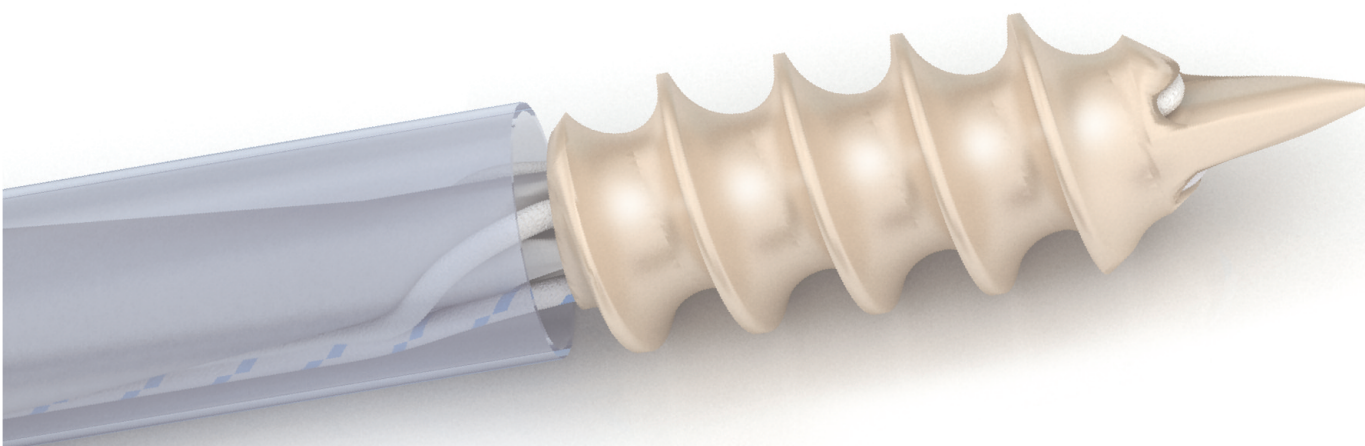

# Aim-tec® ROTATOR

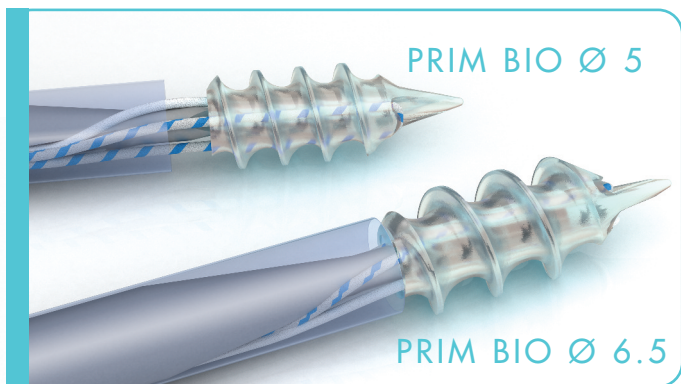

## PRIM BIO

Absorbable screw type suture anchor system for rotator cuff repair

### INDICATIONS

- Designed for soft tissue reattachment to bone :  
5 & 6.5 mm Ø : shoulder
- Arthroscopic or open surgery.

### PROPERTIES

- Pre-drilling necessary in cancellous bone with impactor.
- Tapping necessary in cortical bone.

### FEATURES

- Absorbable anchor made of noncrystalline copolymer, poly (L/DL-lactide) 70-30.
- ETO sterilized
- Preloaded anchor with two braided (UHMWP) polyethylene suture Super-Fiber® #2 in different colors, fitted or not with suture needles.
- Anchor available in different diameters.
- Adapted ancillary kit available.

### ADVANTAGES

- Ready to use anchor system
- Adapted to arthroscopic or open surgery with its own disposable screwdriver
- Suture secured into screwdriver's grooves against thread torsion.

Class III Medical Device

REF.	SIZE in mm
AVRR 52681 F	Ø 5 anchor - 0.6 Ø x 800 Super-Fiber® #2 Round 4/8 curved - L25 needle
AVRR 52690 F	Ø 5 anchor 0.6 Ø x 900 Super-Fiber® #2
AVRR 62681 F	Ø 6.5 anchor - 0.6 Ø x 800 Super-Fiber® #2 Round 4/8 curved - L25 needle
AVRR 62690 F	Ø 6.5 anchor 0.6 Ø x 900 Super-Fiber® #2

Class I Medical Device

REF.	Reusable instrumentation
AVRT 50000	Tap Ø 5 mm
AVRT 65000	Tap Ø 6,5 mm
AVRI 50000	Impactor instrument Ø 5 mm
AVRI 65000	Impactor instrument Ø 6,5 mm

# INSTRUMENTATION

# R O T A T O R

Class I Medical Device

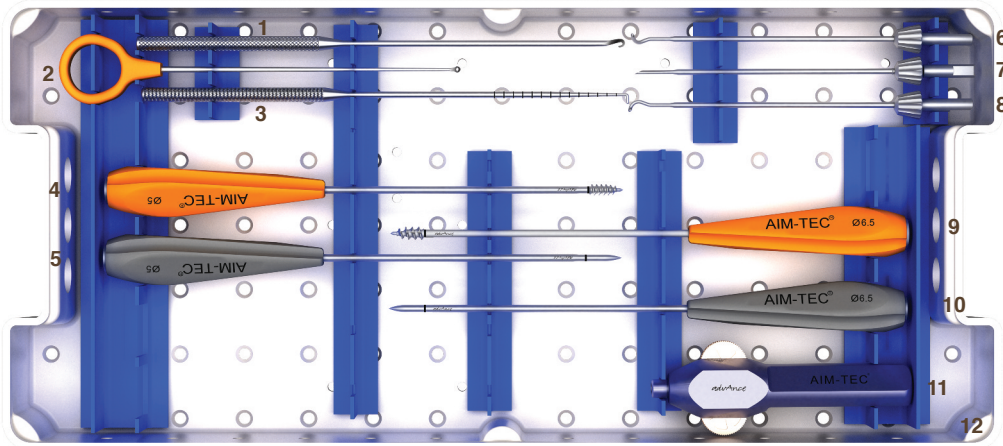

## INSTRUMENTATION

REF.	DESIGNATION
1	AVPF01 Crochet Hook
2	AVPN01 Knot Pusher
3	AVCP01 Probe
4	AVRT 50000 Tap 5 mm Ø
5	AVRI 50000 Impactor instrument 5 mm Ø
6	AVAD01 Suture passer needle, curve right
7	AVAD02 Suture passer needle, straight 0°

REF.	DESIGNATION
8	AVAG01 Suture passer needle, curve left
9	AVRT 65000 Tap 6,5 mm Ø
10	AVRI 65000 Impactor instrument 6,5 mm Ø
11	AVMP01 Suture passer handle
12	AVCI01 Storage tray
12'	AVCP03 Tray cover



Class I Medical Device

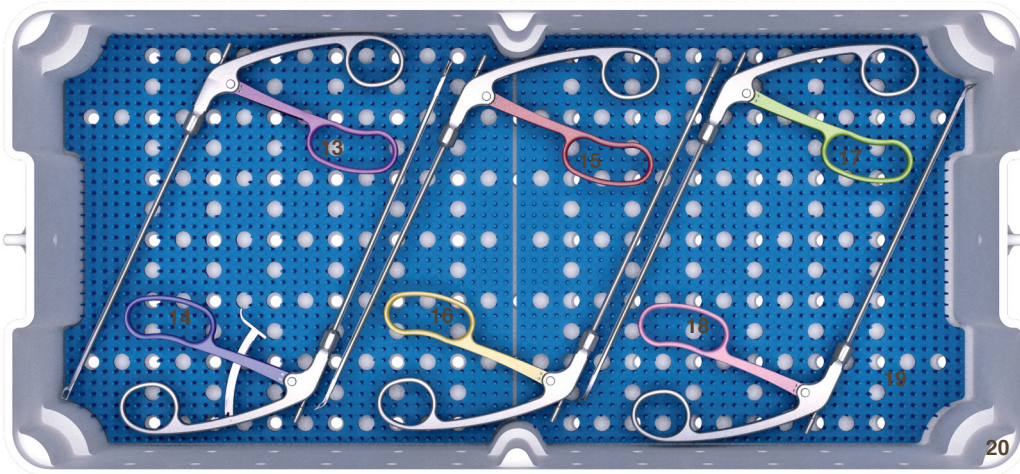

## ADDITIONAL INSTRUMENTATION

REF.	DESIGNATION
13	AVPAF01 Suture retriever
14	AVPAT01 Tissue grasper
15	AVPAU01 Suture penetrator 35° up
16	AVPCF01 Suture cutter
17	AVPCR01 Cleaver hook right
18	AVPCL01 Cleaver hook left
19	AVTS01 Silicone mat
20	AVBA02 Storage container
20'	AVCP05 Container lid



# Nec-plus® ACL / PCL

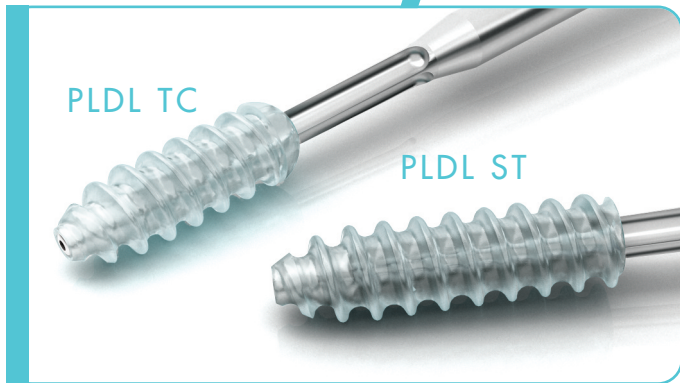

# Nec-plus® KNEE

Absorbable interference screw with curved-headed or headless

## INDICATION

- Reconstruction of cruciate ligaments of the knee.

## DESCRIPTION

- Used for fixations of autologous transplants during knee cruciate ligaments reconstruction.
- Curved-head screws specifically designed for femoral fixations.
- Headless screws specifically designed for tibial fixations.
- Smooth outer screw profile.
- Optimized inner screw design (5 lobes along the entire screw).
- Universal screwdriver, fitting all NEC-PLUS® screw sizes, with "sliding" handle facilitating desinsertion.

## FEATURES

- Poly (L/DL Lactide) 70-30 absorbable screw.
- Polymer from the poly (-hydroxyacid) family.
- Amorphous copolymer.

## CURVED-HEAD SCREW/FEMORAL FIXATION

Class III Medical Device

	REF.	SIZE in mm
	PLDL 07023 TC	7 Ø x L 23
	PLDL 08023 TC	8 Ø x L 23
	PLDL 09023 TC	9 Ø x L 23
	PLDL 10023 TC	10 Ø x L 23

## HEADLESS SCREW/TIBIAL FIXATION

Class III Medical Device

	REF.	SIZE in mm
	PLDL 06020 ST	6 Ø x L 20
	PLDL 07028 ST	7 Ø x L 28
	PLDL 08028 ST	8 Ø x L 28
	PLDL 09028 ST	9 Ø x L 28
	PLDL 09035 ST	9 Ø x L 35
	PLDL 10028 ST	10 Ø x L 28
	PLDL 10035 ST	10 Ø x L 35
	PLDL 11028 ST	11 Ø x L 28
	PLDL 11035 ST	11 Ø x L 35
	PLDL 12028 ST	12 Ø x L 28



# INSTRUMENTATION

# A C L / P C L

Class I & IIa Medical Device

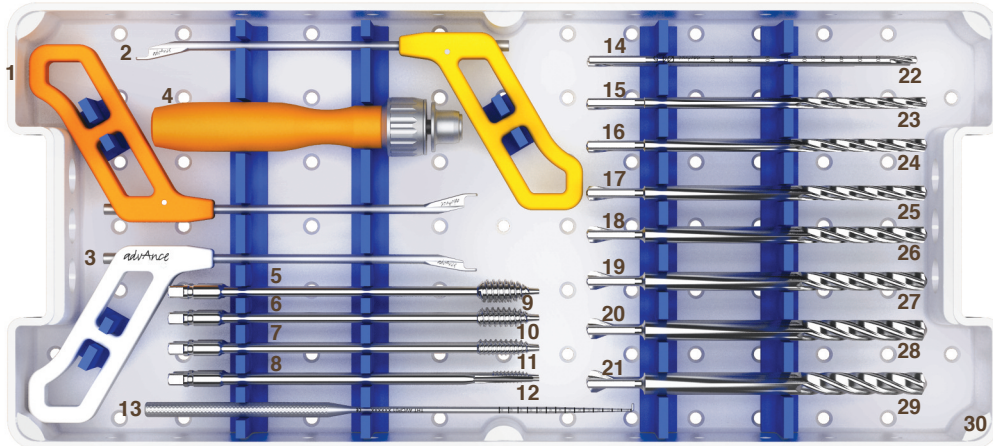

REF.	DESIGNATION
1	NPVF07 Femoral aimer 7 mm
2	NPVF06 Femoral aimer 6 mm
3	NPVF05 Femoral aimer 5 mm
4	NPPE01 Cannulated handle 1/4 square shaft
5	NPTE11 Cannulated tap Ø11 1/4 square shaft
6	NPTE09 Cannulated tap Ø9 1/4 square shaft
7	NPTE07 Cannulated tap Ø7 1/4 square shaft
8	PLDL UM Screwdriver 1/4 square shaft
9	NPTE12 Cannulated tap Ø12 1/4 square shaft
10	NPTE10 Cannulated tap Ø10 1/4 square shaft
11	NPTE08 Cannulated tap Ø8 1/4 square shaft
12	NPTE06 Cannulated tap Ø6 1/4 square shaft
13	AVCP01 Probe
14	NPFC45 Cannulated drill Ø4,5
15	NPFC06 Cannulated drill Ø6

REF.	DESIGNATION
16	NPFC07 Cannulated drill Ø7
17	NPFC08 Cannulated drill Ø8
18	NPFC09 Cannulated drill Ø9
19	NPFC10 Cannulated drill Ø10
20	NPFC11 Cannulated drill Ø11
21	NPFC12 Cannulated drill Ø12
22	NPRC05 Cannulated reamer Ø5
23	NPRC06 Cannulated reamer Ø6
24	NPRC07 Cannulated reamer Ø7
25	NPRC08 Cannulated reamer Ø8
26	NPRC09 Cannulated reamer Ø9
27	NPRC10 Cannulated reamer Ø10
28	NPRC11 Cannulated reamer Ø11
29	NPRC12 Cannulated reamer Ø12
30	NPPA01 Storage tray

Class I Medical Device

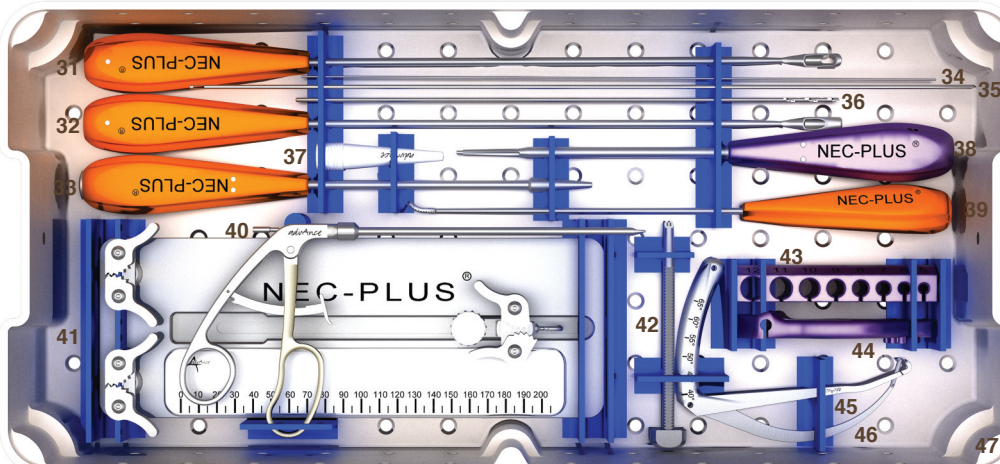

REF.	DESIGNATION
31	NPSO01 Open stripper
32	NPSF01 Closed stripper
33	NPCO01 Tunnel expander
34	PLDL B 1.2-350 Nitinol guide pin Ø1.2/350 mm
35	NPBC24 Wire Ø2.4/430 mm with eyelet
36	NPFC24 Drilling wire Ø2.4/300 mm with eyelet
37	NPBT01 Bone tunnel plug
38	PLDL U Universal screwdriver
39	NPRA01 ACL/PCL rasp

REF.	DESIGNATION
40	AFPCT01 AFIX Braid Suture Cutter
41	NPST01 Graft preparation station
42	NPCV01 Pin sleeve of ACL/PCL aimer
43	NPCA01 Graft sizing block
44	NPPV01 Handle of ACL/PCL aimer
45	NPCT01 ACL tibial aimer
46	NPCF01 ACL out-in femoral aimer
47	NPBA02 Storage container
47'	NPBA03 Container lid



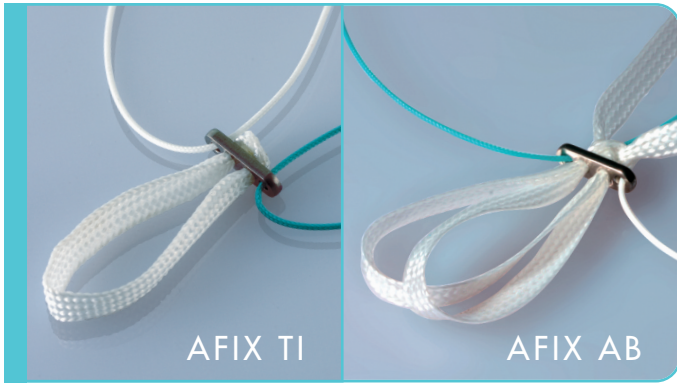

# Aim-fix®

## PLATE

Femoral fixation device

### ADVANTAGES

- Excellent biocompatibility
- Higher breaking point than classical fixation
- Ready to use sterile device

Class IIb Medical Device

	REF.	SIZE in mm
	AFIX 150 TI	L 15
	AFIX 200 TI	L 20
	AFIX 250 TI	L 25
	AFIX 300 TI	L 30
	AFIX 350 TI	L 35

## LOCK

Adjustable and self-locking femoral fixation device

### ADVANTAGES

- Excellent biocompatibility
- Adjustable and self-locking
- Higher breaking point than interference screws
- Ready to use sterile device

Class IIb Medical Device

	REF.	SIZE in mm
	AFIX 400 AB	Adjustable - L 40 max.
	AFPCT01	AFIX Braid Suture Cutter

### INDICATION

Cortical support device for semitendinosus femoral fixation, in ACL reconstruction.

### FEATURES

Fixation device with:

- (TA6V ELI) titanium alloy plate
- (PET) polyethylene terephthalate loop
- polyester traction threads

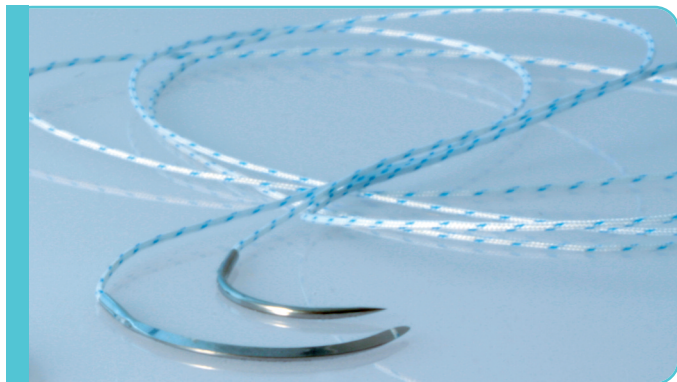

# Super-fiber®

## L I G

### FEATURES

Made of polyethylene suture Super-Fiber® set with suture needles.

### ADVANTAGES

- High tensile strength
- Highly resistant to friction
- 2 thread diameters available
- Set with triangular and round needles

Class IIb Medical Device

	REF.	SIZE in mm
	SFIB 06901 PE	Blue Super-Fiber® #2 - Ø 0.6 x 900 1 Triangular 4/8 curved - L35 Needle 1 Round 4/8 curved - L25 Needle
	SFIB 07901 PE	Blue Super-Fiber® #3/4 - Ø 0.7 x 900 1 Triangular 4/8 curved - L35 Needle 1 Round 4/8 curved - L25 Needle

Ligament and tendon anchorage

### INDICATIONS

- Ligament and tendon reinsertion
- Shoulder and Knee surgery



# Aim-tec® H A N D & F O O T



## MINI PK

POLYETHERETHERKETONE (PEEK) ANCHOR

Screw type suture anchor system for reinsertion

### INDICATIONS

- Designed specifically for soft tissue reattachment to spongy bone : Ø 3 mm : hand and foot,
- Arthroscopic or open surgery.

### PROPERTIES

- Tapping recommended in all bone types.
- Conic-shaped anchor with large amplitude threading : progressive insertion preserves bone.
- Screwdriver's tip designed for complete and powerful screwing : quick, secure and complete (eyelet and anchor insertion).

### FEATURES

- Preloaded anchor with a suture (UHMWP) polyethylene suture Super-Fiber® #2 or #2-0, set with rounded suture needles.

### ADVANTAGES

- Radiotransparent (without interference and interaction with X-ray imaging)
- Ready to use anchor system
- Adapted to arthroscopic or open surgery with its own disposable screwdriver
- Suture secured into screwdriver's grooves against thread torsion.
- Anchor may be easily removed by unscrewing, if necessary

Class IIIb Medical Device

REF. Anchor Thread Needle				
	+	AVRP 30361 F	Ø 3 mm	L 600 mm Super-Fiber® #2-0 L 20 mm Curved 3/8
	+	AVRP 30681 F	Ø 3 mm	L 800 mm Super-Fiber® #2 L 25 mm Curved 4/8

Class I Medical Device

REF. Reusable instrumentation	
	AVRT 30000 Tapping instrument for 3 mm Ø Peek anchor

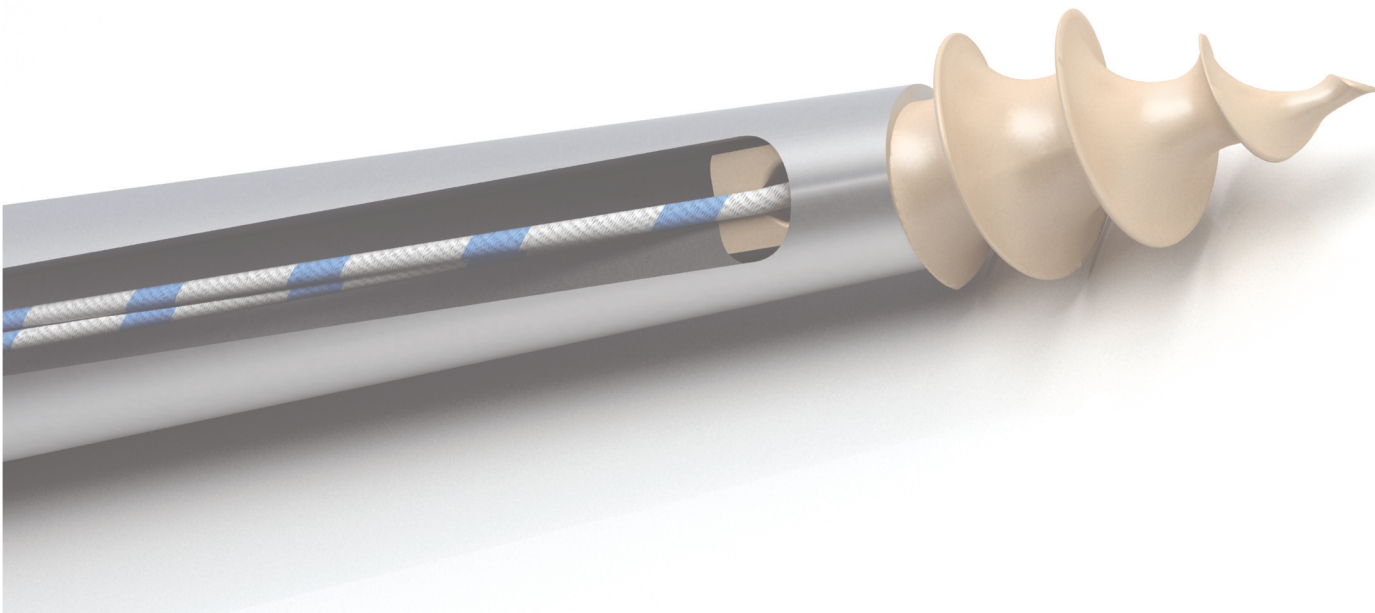

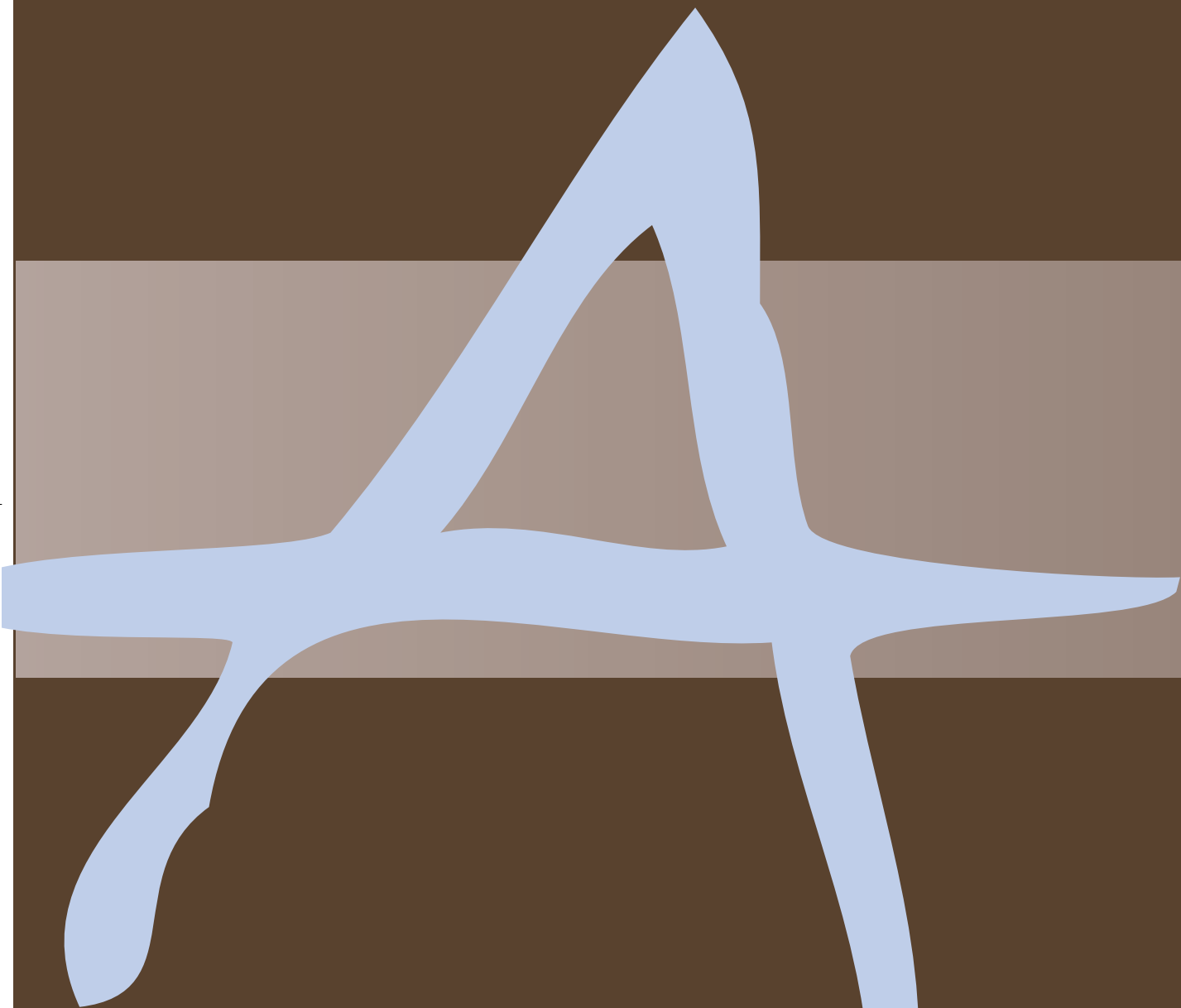

APC V5 - 10/15

*advAnce*  
ARTHRO-SYSTEMS

Customer Service :  
Tél. : +33 (0)5 63 98 76 11  
Fax : +33 (0)5 63 98 10 95

Sales Department : 1, rue d'Albisson - 34000 Montpellier (France)  
Tél. : +33 (0)4 99 58 10 92 - Fax : +33 (0)4 67 54 35 84  
export@thtbio-science.com - www.thtbio-science.com

Made by : **THT**  
bio-science  
G R O U P

